



Hampshire Place

Melksham SN12 7DU

- Two large bedrooms
- In need of some modernisation
- Walking distance to local parks
- Viewing recommended
- Garage and parking
- Close to local amenities
- Nearby primary schools

£210,000 Freehold





Entrance Hall

Window to front elevation, storage cupboard under the stairs, radiator, stairs leading up and doors leading to living room, kitchen and wet room.

Living Room

11'11" x 11'11"

Window to front elevation, radiator.

Kitchen

11'4" x 11'3"

Fitted with a matching range of base and eye level units with worktop space over, 1+1/2 bowl stainless steel sink, space for fridge, slimline dishwasher and washing machine, window to rear elevation, radiator, door leading out to enclosed rear garden.

Wet Room

Fitted with three piece suite comprising shower, wash hand basin and WC.



Landing

Two storage cupboards, doors leading to bedrooms and bathroom.

Bedroom One

10'3" x 19'0"

Two windows to front elevation, storage cupboard, radiator.

Bedroom Two

11'3" x 10'2"

Window to rear elevation, two storage cupboards, radiator.

Bathroom

Fitted with three piece suite comprising bath with shower over and with folding glass screen, wash hand basin and WC, window to rear elevation, radiator.

Utility Area

3'1" x 8'5"

Door leading into garage.

Garage

Window to side elevation, up and over door.



Local Authority **Wiltshire**
Council Tax Band **B**
EPC Rating

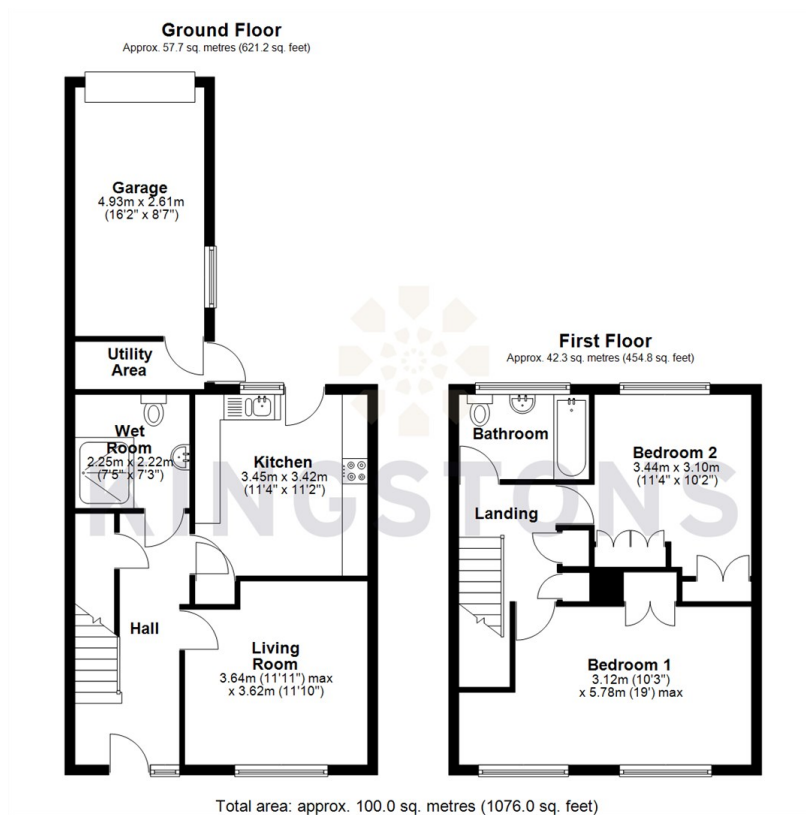

KINGSTONS

Melksham Office

11 High Street, Melksham,
Wiltshire, SN12 6JR

Contact

01225709115
sales@kingstons.biz
www.kingstons.biz

Agents Note: Whilst every care has been taken to prepare these particulars, they are for guidance purposes only. All measurements are approximate and for general guidance purposes only and whilst every care has been taken to ensure accuracy, they should not be relied upon and potential buyers/tenants are advised to recheck the measurements.